

Three-Phase Current Sensor



Description

The Three-Phase Current Sensor is used with the AmsCurrent module for monitoring current changes in each phase of two three-phase circuits. Current threshold values can easily be configured to raise a number of alarms in StartGrid™, GridLight™ and AmPLight™ – all web applications that run on a central server.

It can be utilized for a high number of monitoring purposes, e.g. for detecting power failures, cable breakages, outages, blown fuses, electricity theft etc.

Functionality

Topic	Comments
Type	Current transformer, 3 current sensors per unit
Usage	Outdoor
Transformer ratio	1000:1
Rated current	100A
Nominal current output	0-100 mA
Maximum primary current	250A
Working voltage	Max 600 Vrms
Accuracy	±1.5%
Isolation between primary and secondary	4KV
Operating frequency	48-62 Hz
Volt per Amp ratio at 100A for 100 Ohms load	0.100V/A
Volt per Amp ratio at 10A for 100 Ohms load	0.0986V/A

Connections

I/O	Comments
Leadouts	Power cable, 4 core 22AWG (0.35mm ²), double insulated, 2500±10mm long out of transformer & ends stripped to 10±1 mm, cable diameter max 5.0 mm. Leadout through a built in rubber sleeve. Color code according to schematic and markings drawing.



Technical Specifications

Operational specifications

Storage temp.	-40°C to +85°C
Operating temp.	-40°C to +85°C
Max humidity	95% (non-condensing)
IP grade	IP54
Weight	380 g
Dimension (H x W x D)	50.5 x 131.0 x 16.0 mm

Standards and approvals

IEC 60044-1
IEEE C57.13-1993



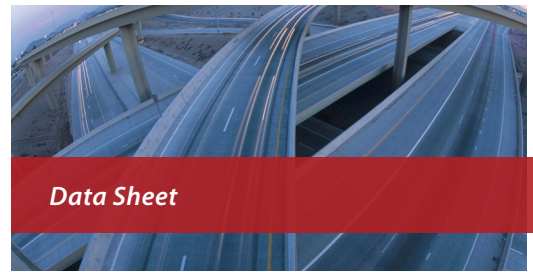

Three-Phase Current Sensor

Front view

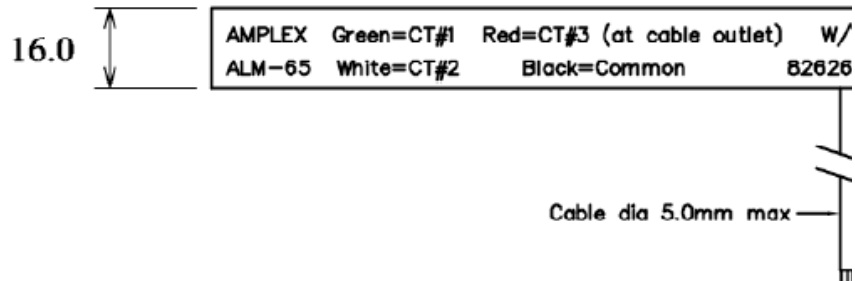

Top view

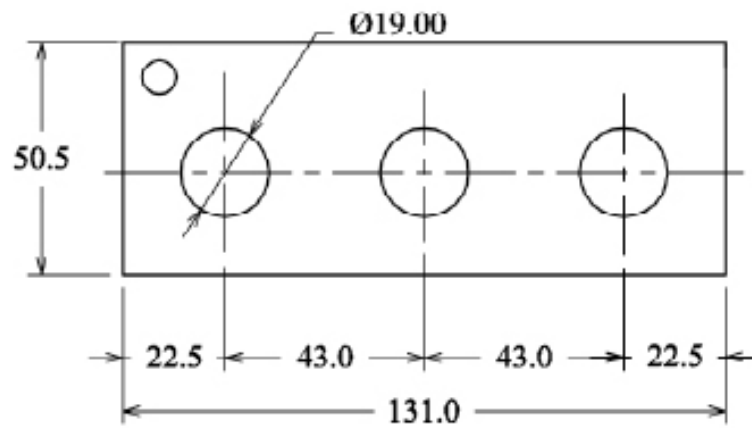

Schematics

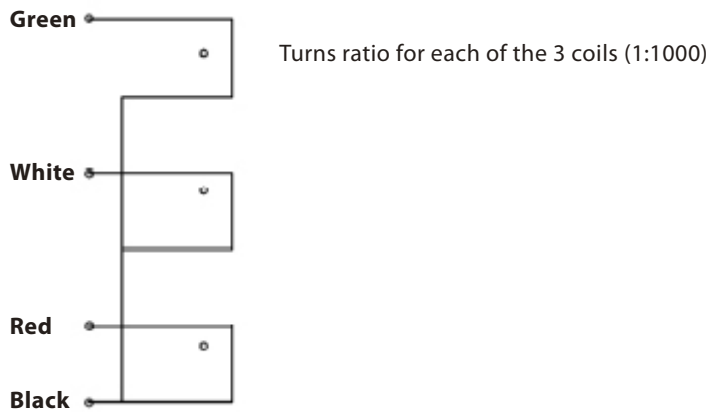

Ordering Information

Product	Order number
Three-Phase Current Sensor	200-10-000
AmsCurrent	100-20-004